

Equine Automation, LLC

Set-up/Operating Manual for Model X5-CD

Programmable Automatic Horse Feeder

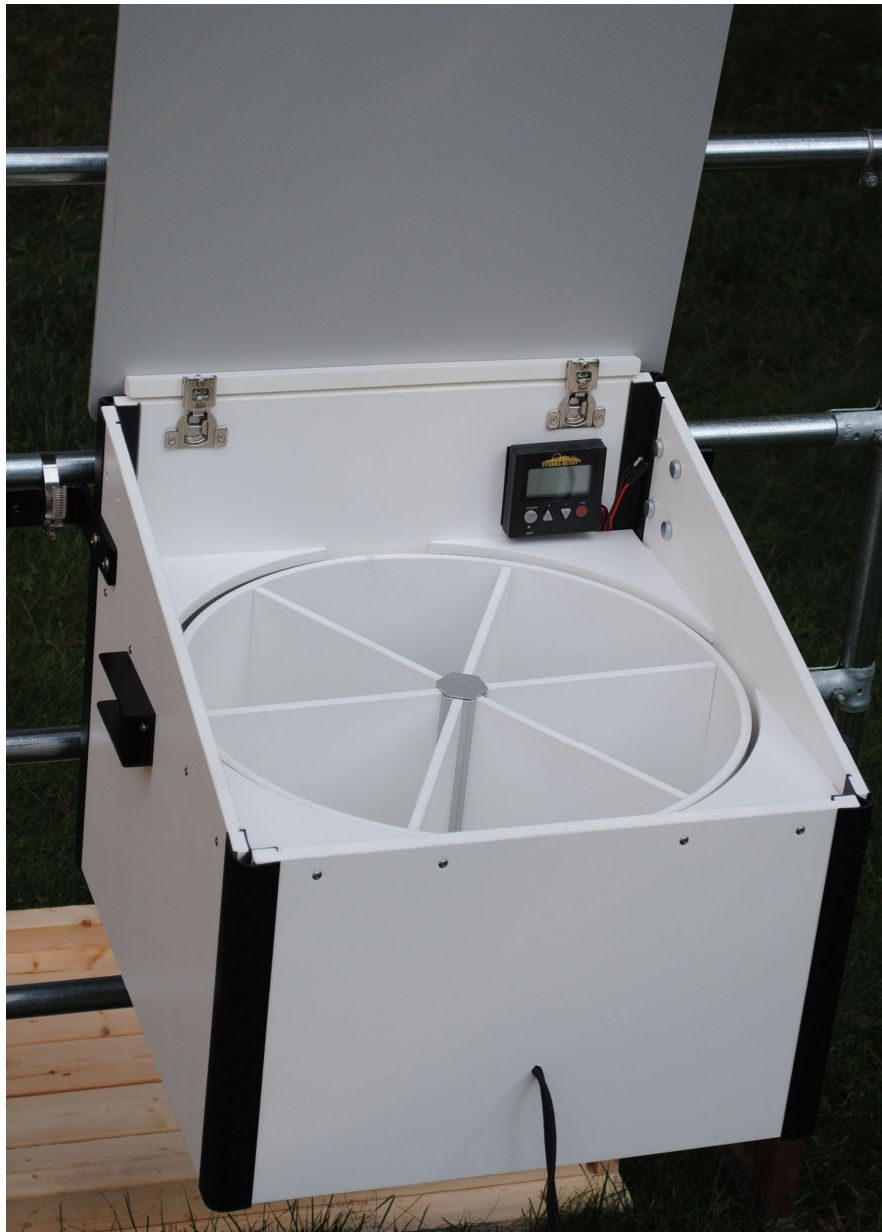

Equine Automation, LLC

Table of Contents

Pages 3 - 6	Installation & Set-up Instructions
Pages 7 - 9	Programming Timer
Page 10 - 11	Recharging Battery
Page 12	Maintenance & Storage
Page 13	Warranty

Equine Automation, LLC

Automatic Feeder Installation & Set-up Instructions

1. **Unpack** Remove all components from packaging. **SAVE THE PACKAGING.** In the unlikely event this equipment needs to be returned the buyer is responsible for packaging and safe transport.
2. **Hanger Bracket Installation** Remove Hanger Brackets from bag, unscrew mounting hardware from side of feeder, reinstall with Hanger Brackets in place and tighten.



3. **Feeder Mounting-Fence, Horizontal Rail** Determine where feeder will be used. If on fence or any type of tubular style structure you will be using the (2) hose clamps.
When mounting to any tubular style fencing or containment the Hose Clamp method is idea. (see photo next page) Simply open hose clamp fully, wrap around fence tube in approximate location of where feeder is to reside and screw clamp partially closed. This should leave the clamp free to be moved along the mounting tube. Repeat this with second clamp. With some help from an assistant lift feeder into position, align with tube and slide clamps over mounting brackets. Move unit to desired place and tighten clamps until unit is secured.



4. **Feeder Mounting - Wall** When mounting to any wooden surface the unit will be screwed on. This will require a drill and screwdriver. The screws supplied are self tapping and do not require a pre-drilled hole, but if you are using a hand screwdriver it is recommended to pre-drill the holes (drill bit provided) to help in the mounting process.

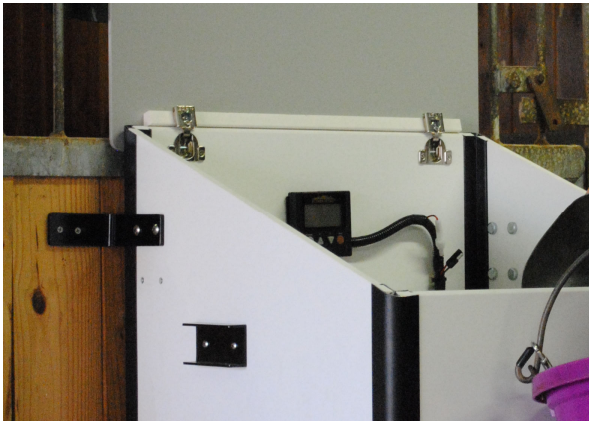

Find a suitable location for the unit. With the help from an assistant hold unit in the proper location and mark the (4) mounting holes. Remove feeder. Using the supplied drill bit, drill all the marked spots approx. 1" deep. **Secure unit using all (4) mounting screws.** See the following illustration for mounting height recommendations.

Note - Due to so many potential applications the mounting may need to be improvised. If you are having trouble, feel free to contact the factory for advice or even special mounting hardware.

Wall opening & Mounting height recommendations

Wall opening dimensions
12" Wide x 6" Tall

Minimum Mounting Height
24" Bottom of Feeder to Floor

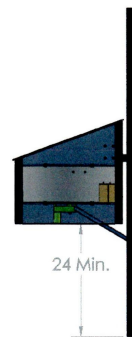
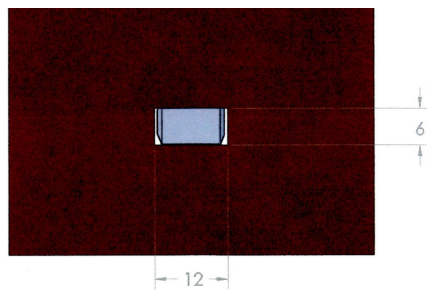

5. **Squaring the Unit** The unit will need to be squared up to its mounting surface. This is achieved by adding the provided Spacer Blocks between the Back Wall of Feeder and the Fence or Mounting Wall. Shims can be combined to reach the correct thickness, once correct stack height is achieved remove tape liner and adhere Shims to backside of unit. (see photo) Spacers **must** be oriented vertically and on or near the black corner moldings.

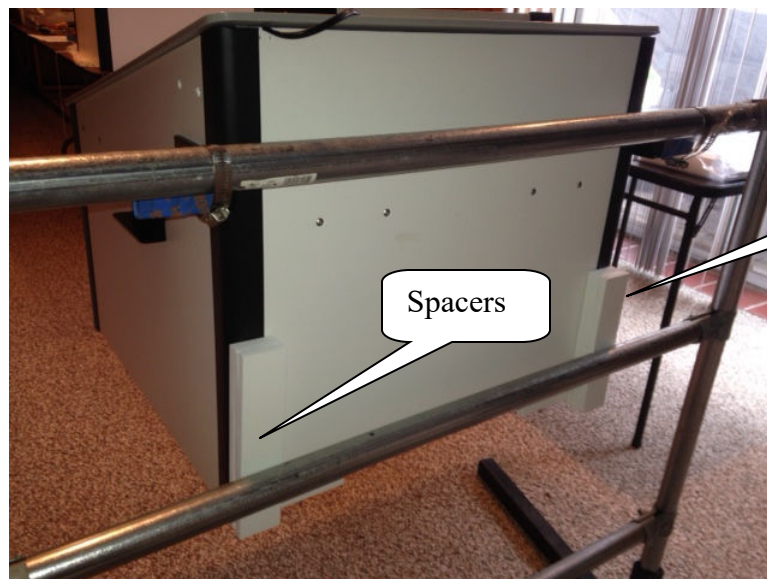

6. **Chute Installation** Remove Chute from bag. Remove the (2) mounting screws from the Gearbox located on the underside of the Feeder (under blue protective tape). It is best to get help from a friend to perform the following steps. With unit on a bench, roll onto side or back, attach Chute using the two screws identified above.

Note-the screws will bottom out short of the Chute being fully secured. This is intentional and by design.

With a pencil in hand, position the unit on the mounting surface with Chute protruding through wall or fence and adjust height until a min of 45 degree chute angle is achieved. (45 degrees will work for most applications but more is sometimes needed and not harmful in any way to normal operation.) Once satisfied use pencil to mark the mounting points. Place feeder aside, spot drill marked holes, then mount feeder using (4) screws provided. It is recommended to trim off any extra protruding chute and with some additional hardware secure the Chute to the wall or structure.

Equine Automation, LLC Programming Timer



Clock Program:

Press right arrow on home screen to enter clock program. Press left arrow when finished.

- Adjust hour with up and down arrow. Press right arrow when complete.
- Adjust minute with up and down arrow. Press right arrow when complete.
- Adjust day with up and down arrow. Press right arrow when complete.

Operation Program:

On main screen, use up and down arrows to change operation mode between QSET1 / QSET2 / Custom.

ALL PROGRAMMING AND OPERATION WILL TAKE PLACE IN CUSTOM MODE. THE FEEDER WILL NOT EXECUTE FEED CYCLES IN QSET1 OR QSET2. THESE OPTIONS ARE NOT TO BE USED.

When in custom mode, press LEFT arrow to enter Timer Programming.

Press Left arrow again to see time slots.

Use UP and DOWN arrows to select time slots.

To make changes to program push Right arrow. (a flashing screen will indicate changes can be performed)

Continue pushing RIGHT arrow to see all configurable settings. When ready to make changes use UP and DOWN arrows. Settings include; Days of the week, Time of day and **Duration MUST BE SET AT 2 SECONDS.**

To SAVE just let unit time out or push LEFT arrow.

Tip – try to get familiar with the sequence so you can navigate swiftly without being “kicked out” repeatedly.

Test Mode:

To test feeder, press and hold right arrow until 5 second countdown begins. When countdown finishes feeder will rotate one complete cycle.

Equine Automation, LLC

Recharging Battery

1. Your unit should be recharged every 4 weeks regardless of what the 5-bar icon meter reads to insure proper operation. If at any time the 5-bar icon meter (located in the upper right corner of display screen) reaches 3 bars or lower the unit should be placed on the charger immediately. Variables affecting charge life are; extreme heat, extreme cold and age of battery.
2. Your feeder comes with a charger. The charger plugs into any standard 110 volt house outlet. The other connector on the charger plugs into the recharge port located inside the feeder several inches from the controller, in the wiring harness. (see photo)



3. To Charge plug two wire plug into charge port. Plug other end onto wall outlet. A charge period of 8 hours or overnight is recommended.
4. **Status Lights on Charger** - The charger will display the following 4 conditions via a red or green LED display;
 - a. **Pulsing Red** - The red light flashing indicates that the battery charger has AC power available and that the micro processor is functioning properly. If the red light continues to flash, then either the battery voltage is too low (less than 4 volts) or the unit is not properly connected.

- b. **Solid Red** - Whenever the red light is on steady, a battery is connected properly and the charger is charging the battery. The red light will remain on until the charger completes the charging stage.
- c. **Pulsing Green** -When the green light is flashing (95% charged), the battery charger will give a 0.5 amp pulse current to charge the battery until full. It will decrease the battery sulfation and improve the battery performance.
- d. **Solid Green** -When the green light turns solid, the charge is complete and the battery charger can be disconnected. Leaving the charger connected after the charge is complete will not do any harm although it is recommended. Store charger in a clean, dry place when not needed.

NOTE - It is not recommended to leave charger on for more than 24 hours.

Option - Equine Automation offers a **Solar Panel** (for an additional fee) which would eliminate the need to ever recharge. This is an ideal solution if a 110 volt power source is difficult to attain. Visit website/call for more details

Equineautomation.com or 203 218-4945

Equine Automation, LLC Maintenance

The Equine Automation Automatic Programmable Horse Feeder is a very low maintenance unit.

From a performance standpoint there is no mandatory maintenance.

Individual preference will dictate how often you choose to clean up the interior of the unit. The Feeder is designed with a lift out Distribution Drum. (See photo)



With the Drum removed a sweep and wipe down cleaning can be performed to the cabinet interior. A wash down of the Cabinet interior is not recommended. The Distribution Drum on the other hand can be cleaned and washed down with a garden hose.

When replacing Distribution Drum, first line up onto center hub and slide on. Then gently rotate Drum until a drop and engagement is felt. Gently push Drum down to fully seat. Replace the Blue Tension Spring and reinstall the Orange Hand knob. Spin on knob 3-5 additional revolutions after initial contact with spring.

Equine Automation, LLC
Warranty

Equine Automation, LLC will repair all material and workmanship defects free of charge for (1) year after the date of purchase. Battery is considered a wear item and has a (1) year replacement warranty.

The warranty does not cover damage, losses, or injury caused by unauthorized repairs, alterations, improper connection, shipping, abuse, theft, neglect or collateral loss.

In most cases a repair can be handled without returning the unit to the factory. The Feeder is designed to be modular, meaning that with basic hand tools, most repairs can be field serviceable. Only shipping expenses related to warranty issues are covered by Equine Automation, LLC.

Please contact Equine Automation, LLC for authorization prior to shipping any components.